

CP #505 LOCKER ROOM/CHANGE HOUSE

BUILDING SPECS AND FEATURES

Building Size:

24' X 80' X 12'

Protection Level:

5psi/200ms Medium Response

Building Details:

This Locker Room / Changing Facility was built to customer specifications with a large men's facility and a small, separated women's area. To contend with temperatures that are often arctic-like, the building required upgraded HVAC and insulation packages. Due to the building's proximity to a sulfur loading station, a pressurized HVAC system was installed, giving employees a break from the overwhelming smells.

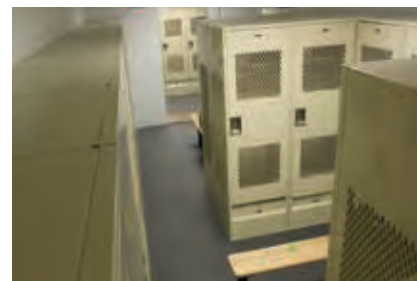

RedGuard is the leading authority in the area of modular safe space, and we are proud to have some of the world's largest corporations as our customers. While we can't always share their names, we share some of the custom projects that they have entrusted to us. We are dedicated to the concept, design, build, install and operation of blast-resistant buildings. We have earned the respect of engineers, architects, contractors, planners and other oil and gas industry specialists throughout the world.

CONTACT US TODAY

TOLL-FREE AT 855.REDGUARD OR EMAIL SALES@REDGUARD.COM

redguard.com



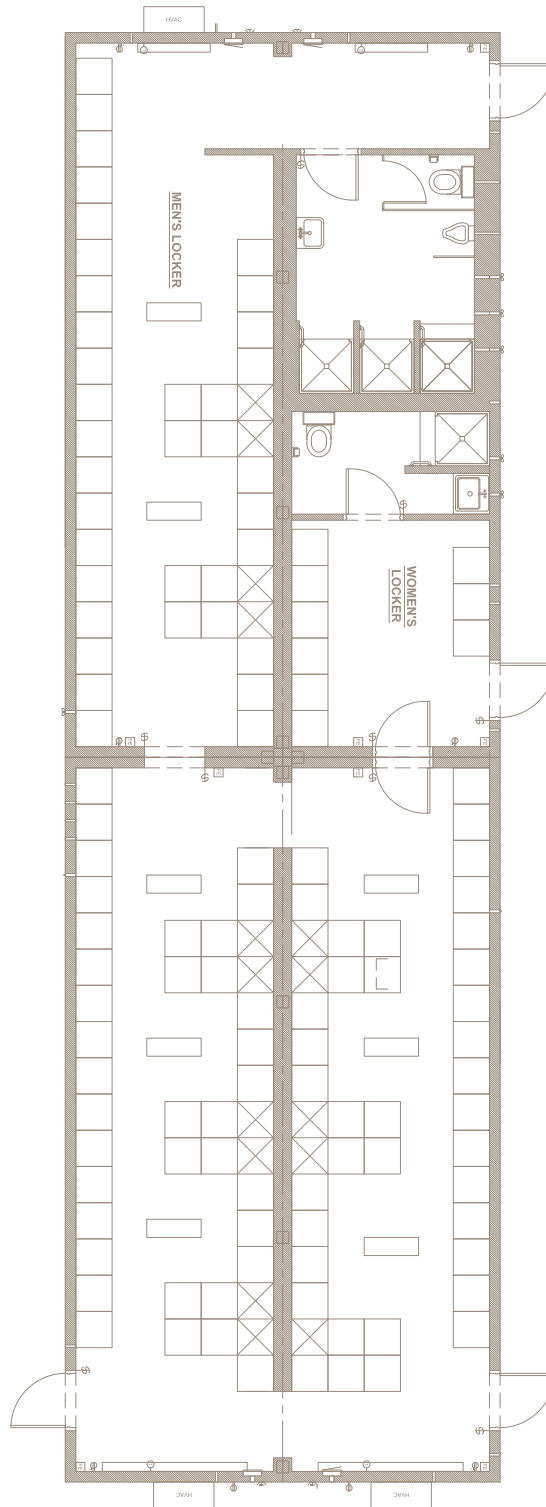

CONTACT US TODAY

TOLL-FREE AT 855.REDGUARD OR EMAIL SALES@REDGUARD.COM

redguard.com

