

This Field Operations building was designed as a multi-use building. It includes a locker room, men's and women's restrooms, electrical-mechanical room, a kitchen/breakroom combo, as well as work areas for permit and field operators. The building was engineered with a pressurized HVAC system and incorporated exterior entry vestibules to help support that system. The exterior of the building required C1, D2 classified electrical and HVAC equipment due to its location inside the facility.

BUILDING SPECS AND FEATURES

Building Size:

28' X 50' X 13.5'

Protection Level:

5 PSI / 200 MS Medium Response

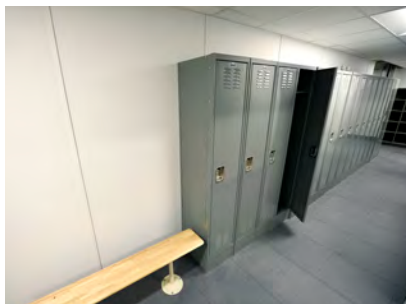
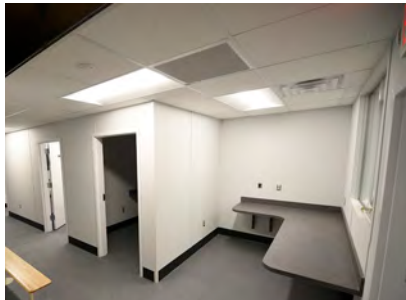

Why RedGuard?

RedGuard is the leading authority in blast resistance and a world leader in providing safe, customizable and scalable modular buildings. RedGuard has aligned with industry-leading strategic partners who are known across the globe, and with a third party engineering firm recognized as the foremost authorities on blast engineering. To save time and money, and to mitigate hazard areas as soon as they are identified, RedGuard can provide you with immediate turnkey solutions, or we can custom engineer a solution based on site requirements.

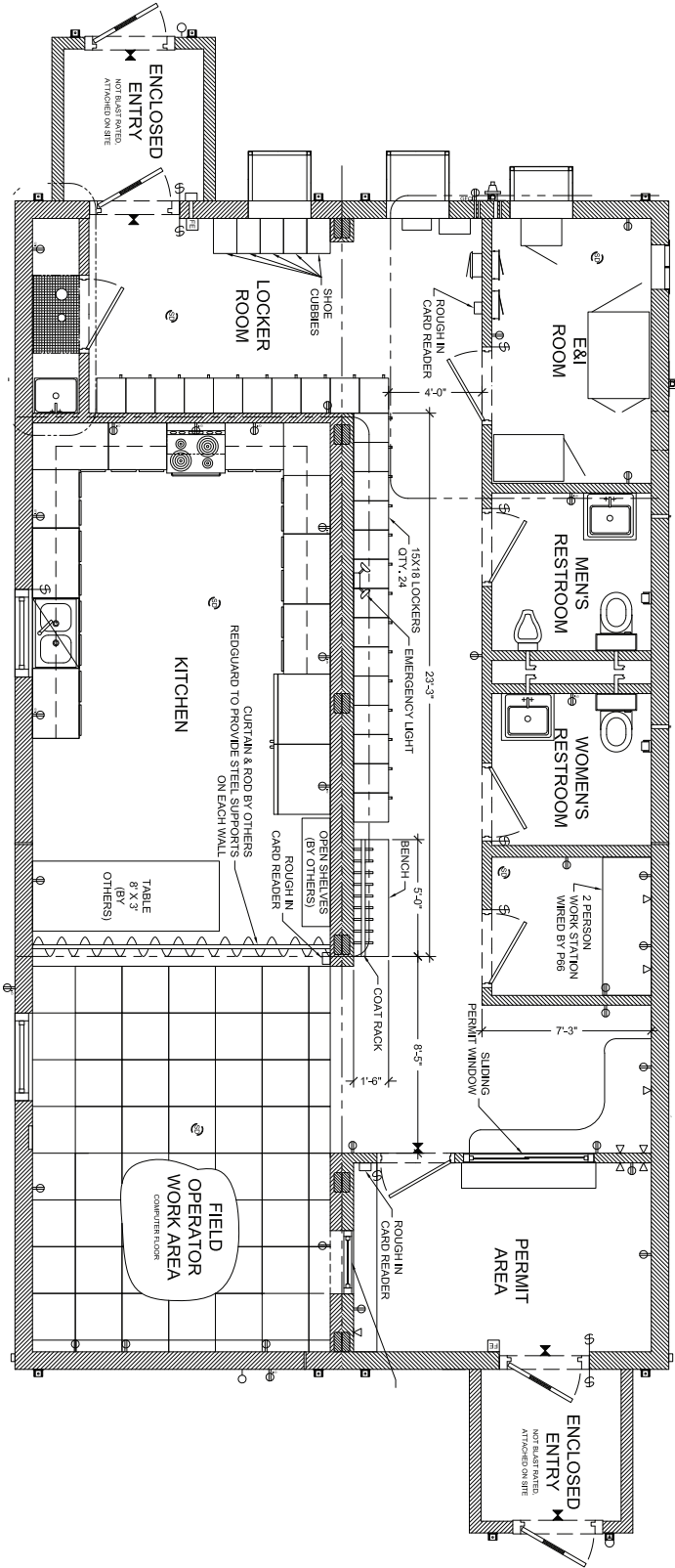

CONTACT US

ONLINE | REDGUARD.COM

TOLL-FREE | 855.REDGUARD

EMAIL | SALES@REDGUARD.COM



OUR GLOBAL FOOTPRINT

Central U.S.A
Wichita, KS
Southern U.S.A
Baytown, TX

Gulf Coast U.S.A
New Iberia, LA
Canada
Calgary, Alberta

Asia
Singapore 508988

Europe
Aberdeen, United Kingdom
Rotterdam, The Netherlands

